

ELIXO

The best you can drink

User Manual

Water filtration system with reverse osmosis

Model: WF-RO-100



EN

Please keep this manual for future reference.

Dear Customer,

Thank you for purchasing our countertop water filtration system. We appreciate your trust and are confident that our product will help you enjoy cleaner, better-tasting, and healthier water every day.

Our filtration system uses the principle of **reverse osmosis**, which is one of the most advanced and effective methods of water purification in the world. This process works by forcing water through a special **semi-permeable membrane** that can capture even extremely small particles.

Thanks to this process, the following are removed from the water:

- | Unwanted minerals causing water hardness (e.g., excess calcium, magnesium),,
- | Salts, heavy metals, and nitrates,
- | Bacteria and viruses,
- | Chlorine and other chemicals that negatively affect taste and quality of water.

Your filtration system also includes **UV light**, which irradiates the water and effectively destroys bacteria, viruses, and other microorganisms. This makes the water even safer and more hygienic.

To ensure not only purity but also proper taste and health benefits, the device is equipped with a **mineralization filter**. After the reverse osmosis process, this filter enriches the water with essential minerals such as **calcium, magnesium, and potassium**, which are beneficial for the human body. The result is **crystal-clear, naturally balanced water**, suitable not only for drinking but also for cooking, preparing coffee, tea, or infant food.

The **ELIXO** brand focuses on overall quality of life. We therefore recommend that you also explore our other products designed to support your health, comfort, and home environment.

We believe you will be satisfied with our filtration system and that it will provide you with long-term comfort and a healthier lifestyle.

General Product Manager Vit Veselenak



TABLE OF CONTENTS

1. Before Installation	1
Package Inspection	1
Technical Specifications	1
Safety Instructions	2
Product Introduction	2
Display	2
2. Operation and Settings	3
First Use	3
Water Dispensing	5
Operating Instructions	6
Filter Replacement Guide	8
3. Maintenance	9
4. Warranty Conditions	10
5. Error Display	11
6. Troubleshooting	12
7. Instructions and Information on Packaging Disposal	13
8. Disposal of Used Electrical and Electronic Equipment	13
9. Important Safety Instructions	13

1. BEFORE INSTALLATION



Before using this appliance, please read the user manual carefully. Use the appliance only as described in this manual. Keep this manual for future reference.

■ Package Inspection

Remove the filtration system from the box and check all components to ensure that nothing is missing or damaged, according to the section "Product Introduction."

The package includes: 1× R0100 filter, 1× AMC100 filter, and 2× pure water pitchers.

Note:

Our package contains one reverse osmosis filter and one mineralization filter, which enriches the water with essential minerals. For special needs, we also offer a non-mineralization filter, available separately, designed for preparing infant water. For newborns and small children, water without added minerals is recommended, therefore we suggest using this filter specifically for preparing infant formula.

The package also includes two pure water pitchers. One pitcher remains permanently installed in the filtration system, and the other can be stored in the refrigerator for cooling filtered water, or used as a spare.

■ Technical Specifications

Dimensions (L×W×H)	23 (L) × 42 (W) × 37.5 (H) cm
Daily Production Capacity	100 GPD
Feed Water Requirement	Municipal tap water
Rated Voltage	230 V
Heating Power	2200 W
Rated Frequency	50 Hz
Feed Water Temperature	4 °C – 38 °C
Replacement Filter Models	Stage 1: R0100 Stage 2: AMC100 (mineralized) Stage 2: AMC101
Tank Capacity	Feed water tank ---- 4,5 L Pure water pitcher ---- 1,4 L

Note:

Do not use with water that is microbiologically unsafe or of unknown quality without proper disinfection before or after using the system.

■ Safety Instructions

1. Do not use with water that is microbiologically unsafe or of unknown quality without proper disinfection.
2. For cold water use only.
3. Do not freeze the filter, as it may crack and cause water leakage.
4. Tests were conducted under standard laboratory conditions, actual performance may vary.
5. Installation must comply with all applicable state and local regulations.
6. For first-time use, please flush the system with 3–5 full feed water tanks.

■ Product Introduction

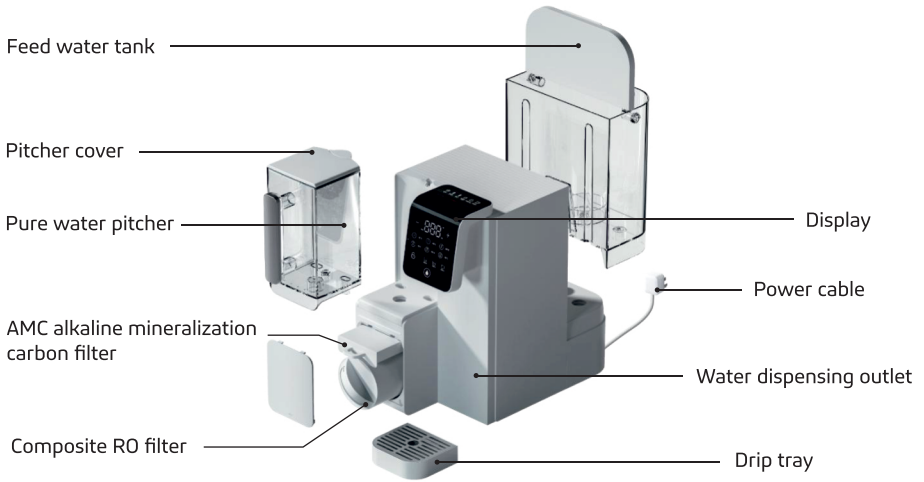

■ Display

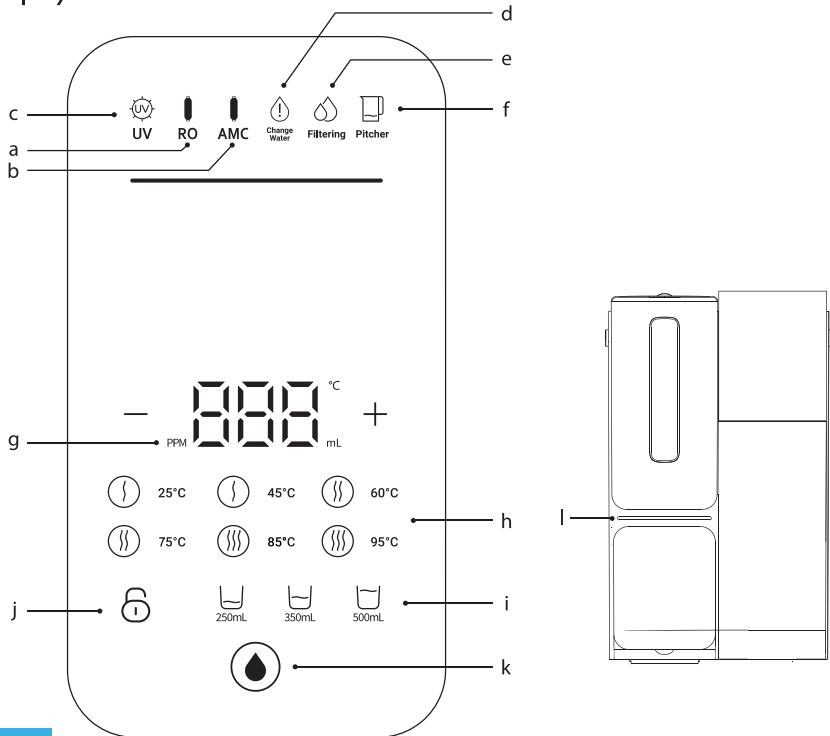

a. RO Filter Life Indicator - White: normal status - Flashing red: replace soon - Red: replace now	b. AMC Filter Life Indicator - White: normal status - Flashing red: replace soon - Red: replace now
c. UV Indicator - Light on: operating - Light off: not operating <small>Note: UV does not work when dispensing heated water ≥ 60 °C</small>	d. Change Water Indicator - Flashing: replace the water in the feed water tank - Light off: no need to change water
e. Filtering Indicator - Light on: filtering water - Flashing quickly: during manual flushing - Flashing slowly: pitcher is not in place - Light off: not filtering water	f. Pitcher Indicator - Light on: pitcher is in place - Flashing: pitcher is not in place
g. TDS Display - Current outlet TDS	h. Dispensing Temperature Indicator - 45/60/75/85/95 °C: dispensing temperature - Deselect: dispence room temperature water
i. Dispensing Volume Indicator - 250 ml / 350 ml / 500 ml: dispensing volume - Deselect: continuous water dispensing for 1 litre	j. Safety Lock (Child Lock) - Light on: system is locked - Light off: system is unlocked
k. Dispense / Stop - Tap to start dispensing - Tap again to stop dispensing	l. Filtered Water Quality Indicator - Blue: filtered water in the pitcher is less than 24 hours old - Red: filtered water in the pitcher is older than 24 hours * The system has not produced water in the last 24 hours and the pitcher has not been removed - Flashing: pitcher is not in place - Off: the system is unplugged or in standby/sleep mode

2. OPERATION AND SETTING

■ First Use

Step 1:

Install the RO filter and AMC filter correctly.
Place the pitcher in position.
Fill the feed water tank with tap water and insert it in place.
Mount the drip tray.

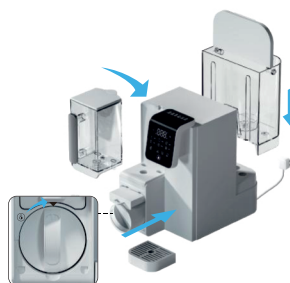

⚠ Important Note: The AMC filter must be fully inserted. Otherwise, the system will not be able to produce water.

Step 2:

Plug the system into the power outlet. The system will start filtering water, and the "Filtering" indicator will light up.



Step 3:

When the "Filtering" indicator turns off, it means the pitcher with pure water is full. Please discard the filtered water from the pitcher and do not consume it.



Step 4:

Put the pitcher back; the system will automatically start producing water again.



Step 5:

Please repeat "Step 2 - Step 4" until the "Change Water" indicator starts flashing. First empty the remaining condensed water from the feed water tank and then refill it with tap water.



1



2



3

Step 6:

The above "Step 1 - Step 5" constitutes one flushing cycle of the system. For first-time use, please repeat this flushing process **3-5 times**.

! Important: Before refilling, always empty the remaining condensed water in the feed water tank. From a 4.5 L reservoir, approximately 3.5 L of pure water is produced, while the remaining 1 L is waste water that must be discharged. The tank should never be refilled without first emptying it completely. Always discard the remaining contents before refilling with fresh tap water. Refilling without this step will shorten the service life of the filter cartridges.

■ Water Dispensing

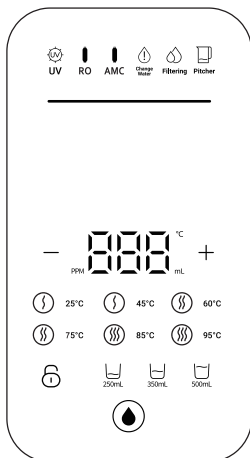

Step 1:

Select the dispensing temperature (25 °C / 45 °C / 60 °C / 75 °C / 85 °C / 95 °C).

To dispense room temperature water, please deselect the temperature button.

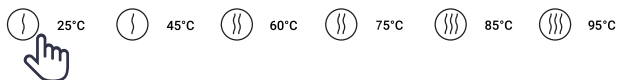

Note: Use \ominus and \oplus to set the dispensing temperature.

Press and hold \ominus and \oplus for quick temperature adjustment.

The heating range is between 25 °C and 100 °C.

Step 2:

Select the dispensing volume (250 ml / 350 ml / 500 ml).

For continuous dispensing, please deselect the volume button.



Step 3:

Tap to dispense water.



Note: To dispense heated water > 45 °C, please touch the child lock first to unlock the system.

Tips:

Room temperature water: deselect the temperature button

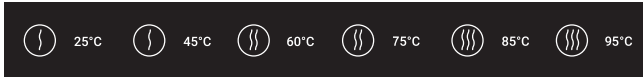

Continuous dispensing: deselect the volume button



Maximum dispensing volume is 1 litre

Stop dispensing: Tap the button  again to stop dispensing water.

■ Operating Instructions:

Child Lock / Unlock

To dispense heated water > 45 °C, first unlock the child lock.



Touch the button to unlock. Touch the button again to lock the system.



Water Replacement



Change Water

The "Change Water" indicator flashes when:

- A. The water level in the feed tank is below the minimum level.
- B. The water in the feed tank is older than 48 hours.
- C. The feed tank is not installed properly.

! Important: Before refilling, always empty the remaining condensed water in the feed water tank. From a 4.5 L reservoir, approximately 3.5 L of pure water is produced, while the remaining 1 L is waste water that must be discharged. The tank should never be refilled without first being emptied. Always discard the remaining contents before refilling with fresh water. Refilling without this step will shorten the service life of the filter cartridges.



Filtering

"Filtering" indicator on: the system is filtering water. "Filtering" indicator off: water filtration is complete. When you remove the pitcher, use a certain amount of water, and then place it back, the system will automatically start filtering again. If the pitcher is in place, the system will automatically start filtering water after 60 seconds of continuous dispensing.

Flushing

■ Automatic Flushing:

- a. The system automatically flushes for 10 seconds before and after each water production.
- b. When the pitcher is full, the system automatically flushes for 60 seconds after changing the water.
- c. During water production, the system performs 2 pulse flushes every 2 minutes.

Manual Flushing: Hold  and  for 3 seconds, the system will beep and flush for 3 minutes.

End of Flushing: Hold  and  again for 3 seconds, the system will beep and stop the flushing mode.

Note: Manual flushing cannot be performed if the pitcher is full.

TDS Display

The TDS value will be shown when the system is in standby mode. The number on the panel is the TDS result after each water production.

TDS (Total Dissolved Solids) indicates the concentration of all dissolved solids in water, especially mineral ions, salts, and trace organic compounds. The value is expressed in ppm (mg/l) and is determined based on the electrical conductivity of the water, which increases with the amount of ions in the solution.

- 0–50 ppm: demineralized to distilled water
- 50–200 ppm: physiologically suitable drinking water
- 200–500 ppm: increased mineral content (hard water)
- > 500 ppm: according to most standards no longer suitable for drinking purposes

TDS measurement does not provide a specification of individual substances, but serves as a comprehensive indicator of water mineralization and purity, and as a control parameter for the efficiency of filtration systems.

One-Touch Draining

Start draining process: Hold  and  for 3 seconds. The panel will start flashing.

Touch the  button to drain water from the pitcher and the internal water circuit.



("888" and the dispense button will flash)

End draining process: Hold  and  again for 3 seconds to exit the one-touch draining mode.

Note: After the one-touch draining operation, for safety reasons (to prevent dry heating), room temperature water will appear first during the next dispensing, followed by hot water.

Standby Mode

After dispensing, the device will return to standby mode if no action is taken within 30 seconds. All indicators will turn off and the TDS value will be displayed. Touch any button to activate the interface.

Sleep Mode

The system will enter sleep mode if no action is taken within 5 minutes. All indicators will turn off. Touch any button to activate the interface.



Filter Replacement Instructions

The ELIXO WF-RO-100 countertop filtration system requires periodic maintenance and cleaning. It is recommended to replace the filter cartridges according to the intervals below.

Filter Number	Approximate Expected Lifetime
R0100	1 year
AMC100	90 days

Note: All stated lifetimes are based on laboratory tests and supplied water quality. The actual lifetime depends on the quality of the source water and daily consumption.

Filter Life Reminder

Indicator	RO/AMC Control	Filter Status	Remaining Lifetime
	White	Normal	> 10%
	Red Flashing	Replace soon	<10%
	Red	Replace now	Expired

Filter Replacement Instructions

Step 1: Disconnect the power supply and remove the filter cover.



Step 2: Remove the filter cartridge that needs to be replaced and insert a new one.

Replacing the RO Filter



Turn the old filter counterclockwise.

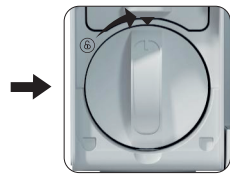

Turn the new filter clockwise.

Replacing the AMC Filter



Pull out the old filter



Insert the AMC filter fully until it stops

! Important Note: The AMC filter must be fully inserted. Otherwise, the system will not be able to produce water.



Step 3: Plug in the system and flush the new cartridge with 3–5 tanks of feed water.



(See "First Use")

Step 4: Reset the filter life

Reset RO filter life:

Hold  and  for 3 seconds, the system will beep and the reset is complete.

Reset AMC filter life:

Hold  and  for 3 seconds, the system will beep and the reset is complete.

Note: After each filter replacement, a reset is necessary.

3. MAINTENANCE

■ If the system has not been used for at least 2 days:

It is recommended to discard the remaining water from the feed water tank and pour out the first two pitchers of filtered water before consumption.

■ If the system will not be used for more than 1 week:

Empty the remaining water from the feed water tank and the pitcher. Unplug the system, remove the filter cartridges, and store them in the refrigerator (**not in the freezer!**). Before the next use, flush the system with 3–5 tanks of feed water (see "First Use").

■ Clean the drip tray regularly (recommended once a week) to prevent bacterial growth and overflow of residual water.

■ Replace the filter cartridges regularly according to the control light indicators of filter life.

Cleaning the Rear Water Tank:

Feed Water Requirements:

Municipal tap water TDS < 800 ppm Hardnes < 250 mg/l

Recommendation: If your feed water does not meet these requirements, the lifetime of the filter cartridges may be shortened.

Do not use water of unknown quality or microbiologically unsafe water without prior disinfection.

To ensure smooth water flow and prolong the lifetime of the filter elements, it is recommended to clean the feed water tank at least once a week.

Procedure for Cleaning the Feed Water Tank:

Use a descaling agent (e.g., citric acid), soak the tank for 30 minutes, and then clean it thoroughly. Do not use organic solvents such as alcohol. Do not use steel wool, abrasive cleaners, or corrosive liquids such as gasoline or acetone.

Check that both check valves on the bottom side are clean and unobstructed.



Cleaning the Filter Screen:

Remove the stainless steel filter screen and clean it with a small brush.



4. WARRANTY CONDITIONS

This product is covered by a warranty period of 24 months (12 months for companies) from the date of purchase. The warranty can only be claimed with proof of purchase.

5. ERROR DISPLAY

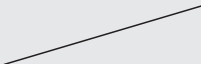
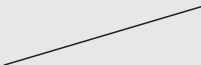
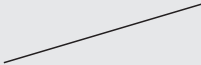
Error Code	Problem	Malfunction	Solution
E1	Outlet temperature sensor fault	Cannot dispense water	1. Reconnect the system. 2. If the problem persists, contact customer service.
E2	Flow meter without water or pump without water	Cannot dispense heated water	Check if the tank is empty.
E4	Heating film circuit fault	Cannot dispense heated water	1. Reconnect the system. 2. If the problem persists, contact customer service..
E5	Freezing alarm	Cannot dispense water	Do not add feed water below 1 °C.
E7	Zero circuit fault	Cannot dispense heated water	1. Reconnect the system. 2. If the problem persists, contact customer service.
EU	Communication error	No response from display buttons	1. Reconnect the system. 2. If the problem persists, contact customer service.
EB	Pump – open circuit	Cannot dispense heated water	1. Reconnect the system. 2. If the problem persists, contact customer service.
H1	Inlet temperature sensor fault		1. Reconnect the system. 2. If the problem persists, contact customer service.
H2	Voltage sensor fault		1. Reconnect the system. 2. If the problem persists, contact customer service.
H3	Overheating (hot water)	Cannot dispense hot water	Check if the tank contains water and dispense several cups of room-temperature water to cool down.
H4	Ultra high temperature	Nelze vydat vodu	Check if the tank contains water and let the system cool down. 1. Reconnect the system. 2. If the problem persists, contact customer service.
H5	Water production timeout	Nelze vyrábět RO vodu	1. Reconnect the system. 2. If the problem persists, contact customer service.
H8	Liquid level sensor fault		1. Reconnect the system. 2. If the problem persists, contact customer service.

6. TROUBLESHOOTING

Problem	Possible Cause	Solution
Cannot dispense room temperature water	System not powered (plug loose or not connected).	Check if the plug is connected.
	“Change Water” indicator flashing, feed tank empty.	Empty the feed water tank first, then refill with tap water.
	Pitcher is empty.	Wait until the pitcher has enough filtered water.
	Touch panel is damaged.	Contact customer service.
Cannot dispense hot water	System is in “dry heating alarm” state.	Dispense several cups of room-temperature water, then dispense hot water.
	Pitcher is empty.	Wait until the pitcher has enough filtered water
System not processing water	Filter cartridges not installed correctly.	Disconnect the system and reinstall the filter cartridges correctly.
	“Change Water” indicator flashing.	Empty the feed water tank and refill with tap water.
	Feed tank or pitcher not in place.	Ensure the feed water tank and pitcher are properly in place.
Water leakage	Water overflowing from drip tray.	Regularly empty the drip tray.
	Water leaking inside the system.	Disconnect the system and contact customer service.
	Water leaking from filter cartridges.	Disconnect the system and reinstall the filter cartridges correctly.
	“Pitcher” indicator flashing, pitcher not in place and water leaking during filtering.	Place the pitcher correctly.
Filtered water tastes unusual	Filter cartridges not flushed enough.	Flush the system with 3–5 tanks of feed water (see “First Use”).
	System not used for a long time.	Flush the system with 3–5 tanks of feed water (see “First Use”).
	Filter cartridges expired and not replaced in time.	Replace the corresponding filters in time (see “Filter Replacement Instructions”).
No response from display button	Display is damaged.	Contact customer service.

7. INSTRUCTIONS AND INFORMATION ON PACKAGING DISPOSAL

Dispose of used packaging material at designated waste collection points.

8. DISPOSAL OF USED ELECTRICAL AND ELECTRONIC EQUIPMENT



This symbol on the product or in the accompanying documentation means that used electrical and electronic equipment must not be disposed of with regular household waste. For proper disposal, recovery, and recycling, take these products to designated collection points. Alternatively, in some EU countries or other European countries, you may return your used products to the local retailer when purchasing an equivalent new product. Proper disposal of this product helps preserve valuable natural resources and prevents potential negative impacts on the environment and human health that may result from improper waste disposal.



This product complies with all essential requirements of the applicable EU directives.

9. IMPORTANT SAFETY INSTRUCTIONS

- If the appliance is damaged due to failure to follow the instructions in this manual, the warranty becomes void. The manufacturer/distributor accepts no liability for damage caused by failure to follow the instructions in this manual. Careless use of the appliance is not in accordance with the terms of this manual.
- Before connecting the appliance to a power socket, ensure that the rated input voltage of 230 V matches the mains voltage of the outlet.
- Connect the appliance only to a properly grounded socket.
- Children must not play with the appliance.
- Do not use the appliance for purposes other than those intended.
- If you do not use the appliance or plan to clean it, always turn it off and unplug it from the socket.
- Do not use the appliance if it is not working properly, has been dropped, damaged, or immersed in water. Never attempt to repair it yourself.
- Do not place any modifications on the appliance – risk of electric shock. All repairs and adjustments must be carried out by qualified service personnel.
- Do not use the appliance by pulling the power cord – this may damage the cord or the outlet.
- Do not place heavy objects on the power cord. Ensure that the cord is not cut, compressed, or damaged.
- Protect the power cord from sharp edges or hot surfaces.
- Always disconnect the appliance from the mains before assembling, cleaning, or handling it.
- This appliance is intended for household use only.
- Do not place the appliance near sources of heat.

